

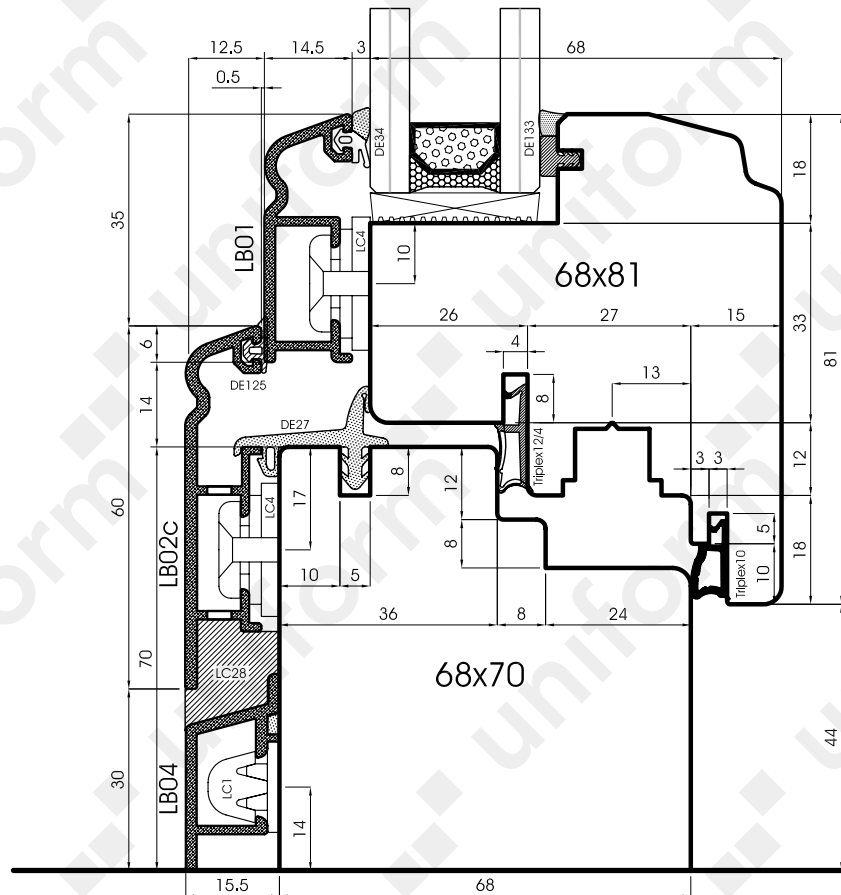

**Bronzo 5000/S e Bronzo Quadra**

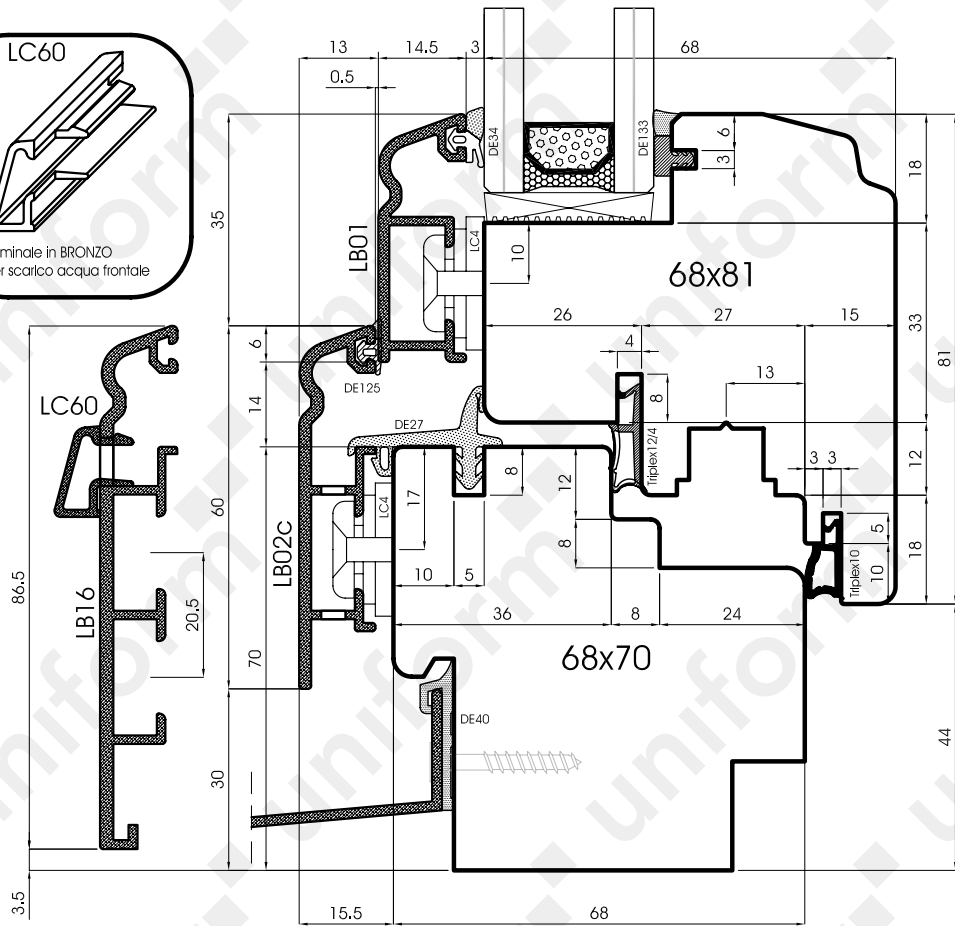
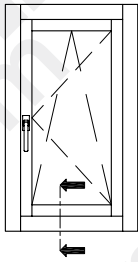
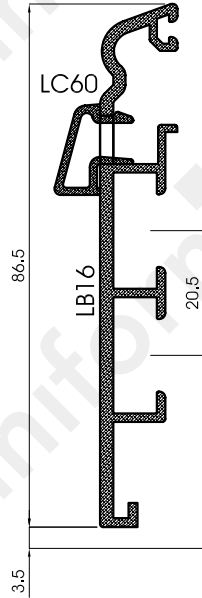

Serie Bronzo 5000/S

Bronzo 5000/S

uniform

Scala 0.8:1

11.02

- Ⓘ Sezione verticale trasverso inferiore finestra
- Ⓓ Vertikalschnitt Fenster quer unten
- Ⓔ Sección vertical travesaño inferior de la ventana
- Ⓕ Coupe verticale traverse inférieure fenêtr
- Ⓚ Vertical section of the window's lower ledger

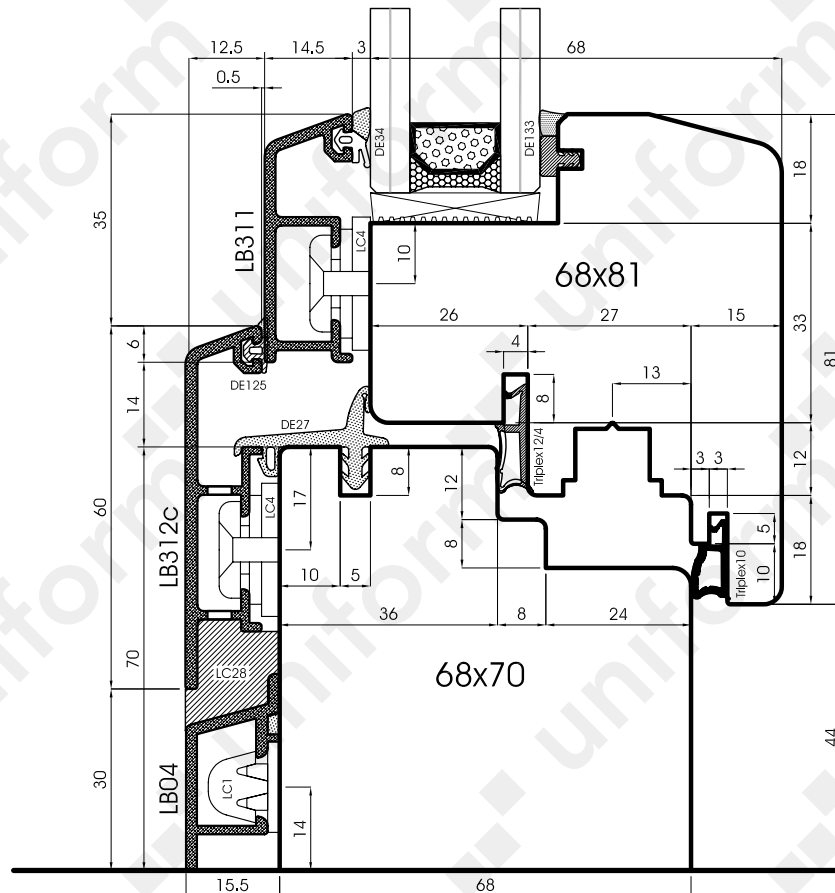
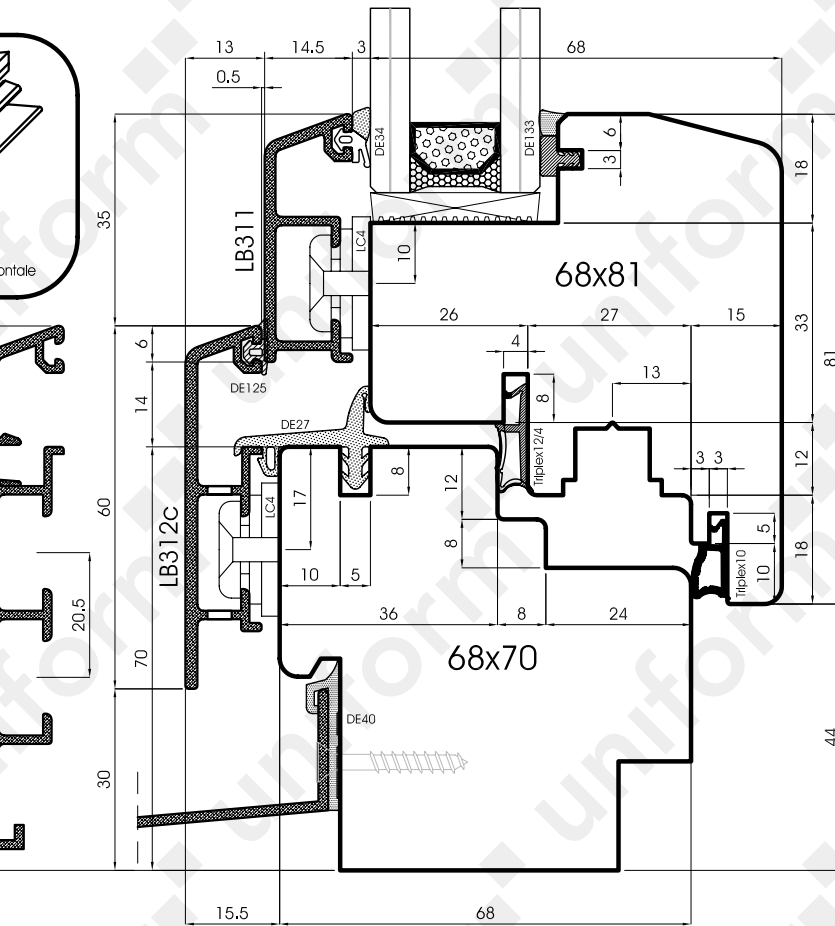
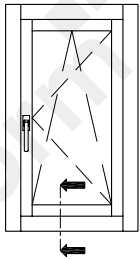
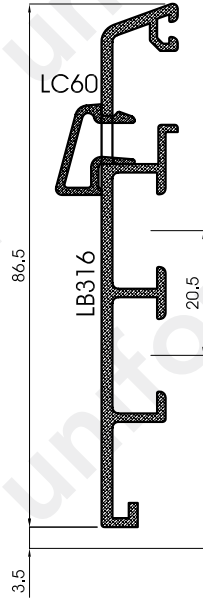

Serie Bronzo Quadra

Bronzo Quadra

uniform

Scala 0.8:1

11.03

- Ⓘ Sezione verticale trasverso inferiore finestra
- Ⓓ Vertikalschnitt Fenster quer unten
- Ⓔ Sección vertical travesaño inferior de la ventana
- Ⓕ Coupe verticale traverse inférieure fenêtr
- Ⓚ Vertical section of the window's lower ledger

Profili serie Bronzo 5000/S

Profili anta

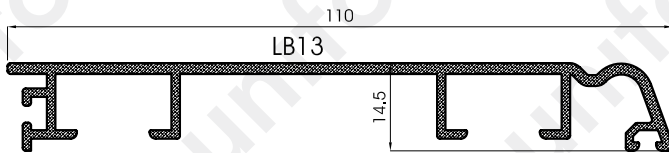
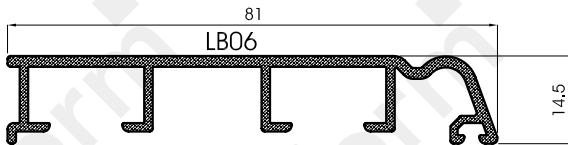
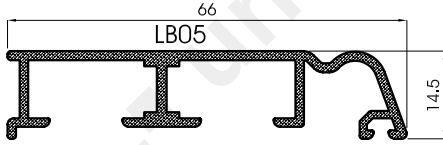
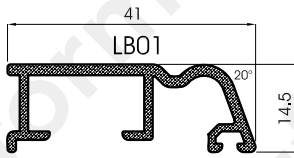

Profili telaio

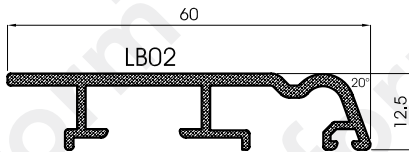

**LB02c**  
con asole scarico acqua

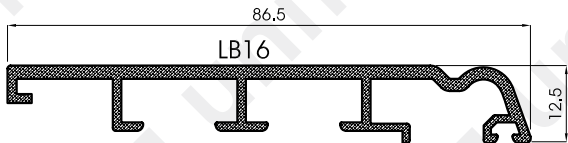

**LB16c**  
con asole scarico acqua

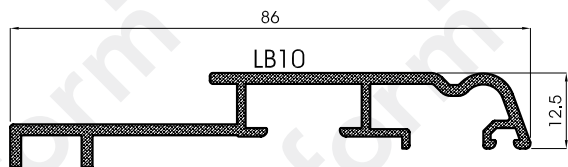

Profili serie Bronzo Quadra

Profili anta

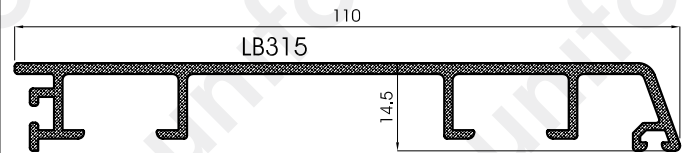
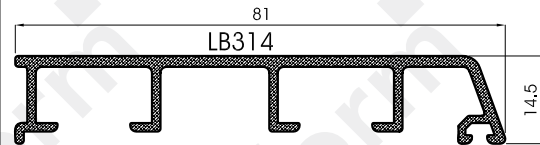
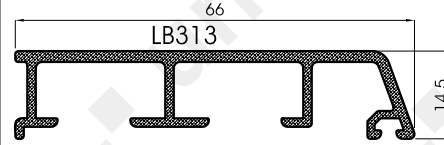
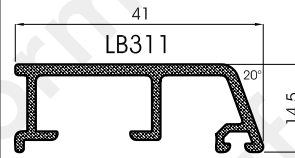

Profili telaio

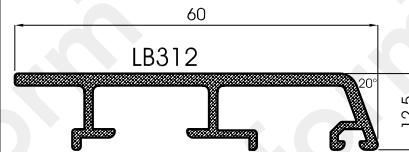

**LB312c**  
con asole scarico acqua

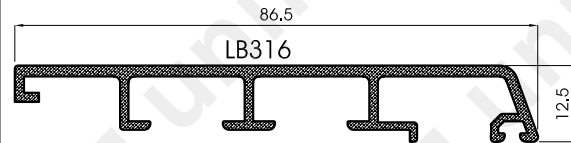

**LB316c**  
con asole scarico acqua

Bronzo Quadra



Scala 0.8:1

11.04

- ① Profili anta e telaio serie Bronzo 5000/S e Bronzo Quadra
- ② Rahmenprofile und flügelprofile für System Bronze 5000/S und Bronze Quadra
- ③ Perfiles del marco y de la hoja para Bronce 5000/S y Bronce Quadra
- ④ Profils du dormant et de l'ouvrant de la gamme Bronze 5000/S et Bronze Quadra
- ⑤ Frame and sash profiles Bronze 5000/S and Bronze Quadra series

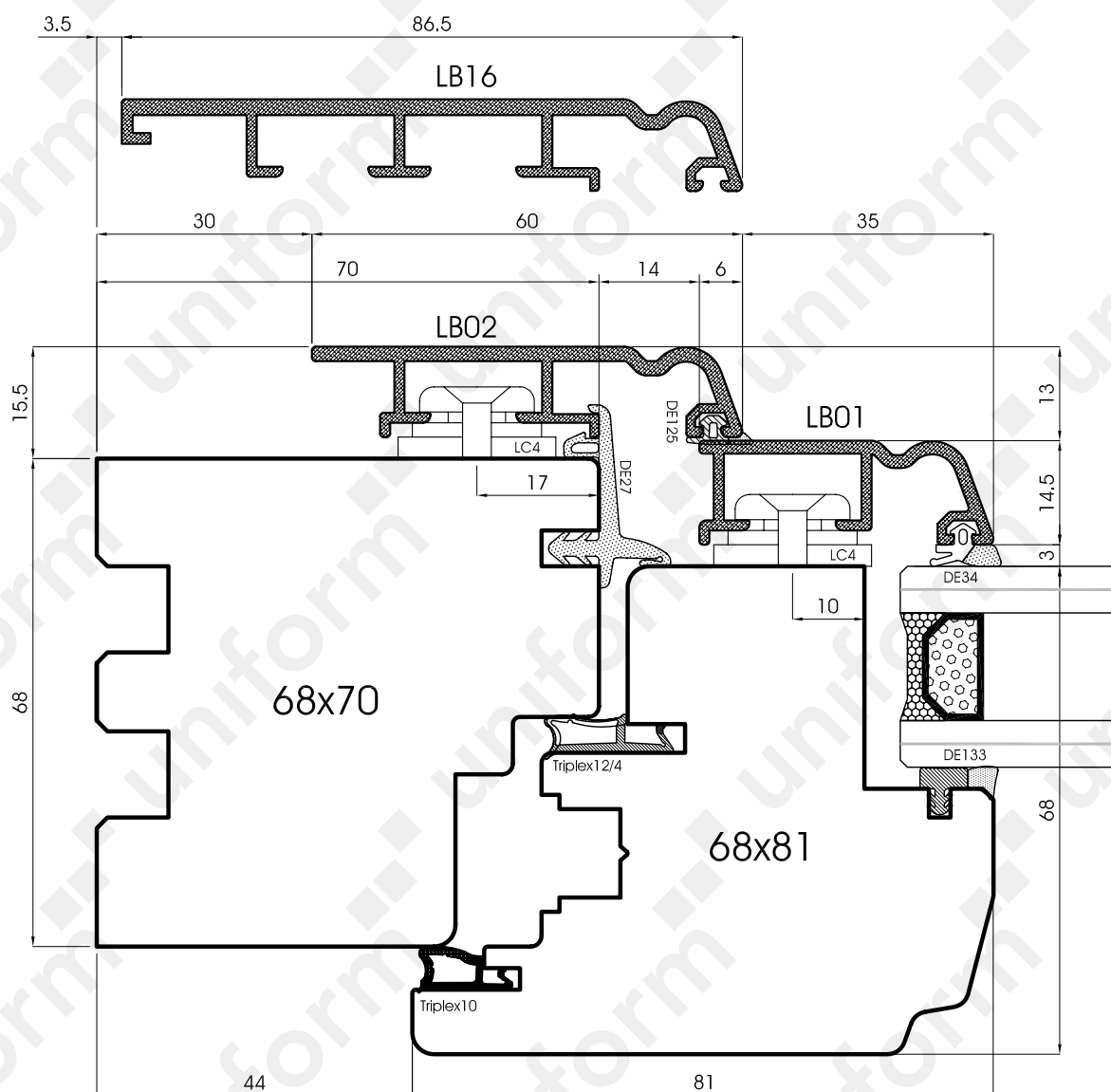
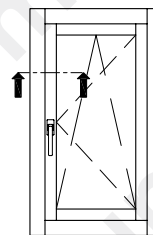

Bronzo 5000/S

uniform

Scala 1:1

11.05

- Ⓘ Sezione orizzontale montante laterale
- Ⓓ Horizontalschnitt senkrecht seitlich
- Ⓔ Sección horizontal de montante laterale
- Ⓕ Coupe horizontale montant latéral
- Ⓚ Horizontal section of the lateral jamb

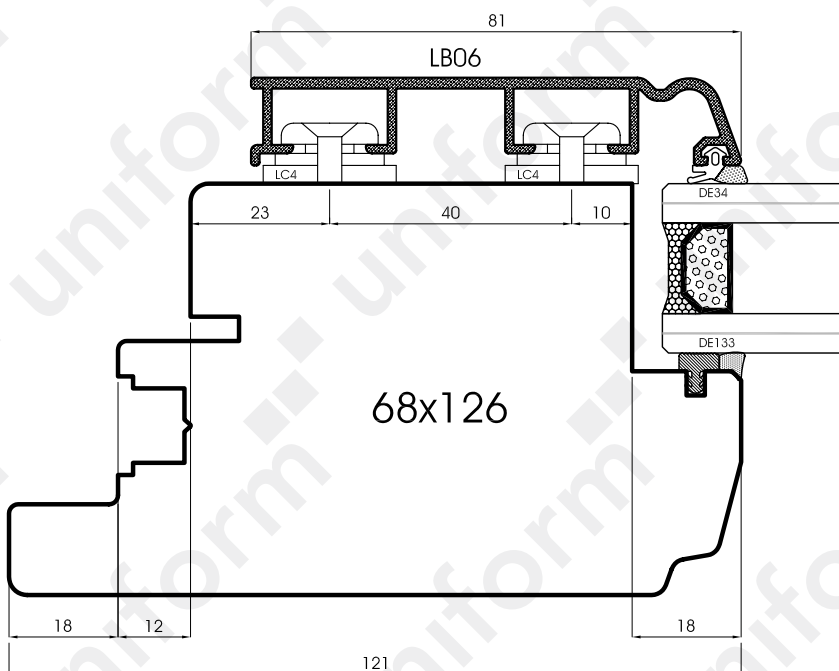
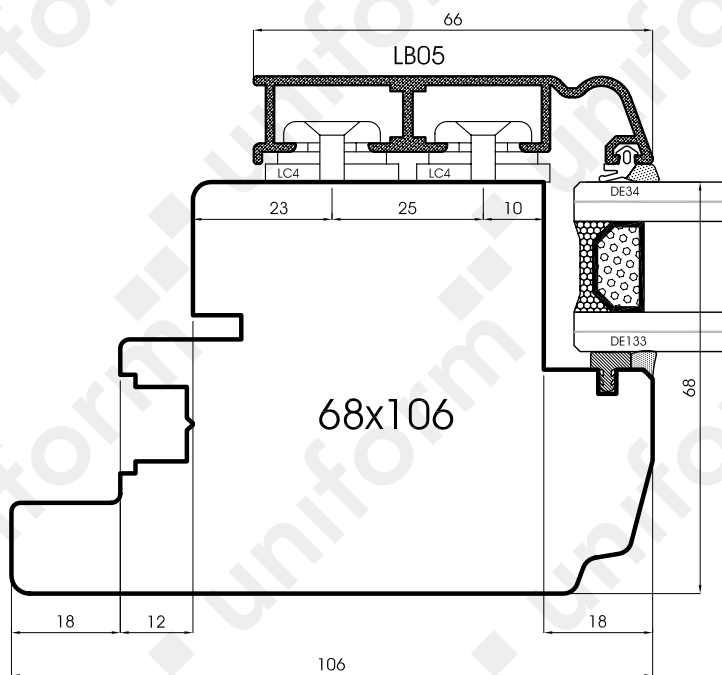
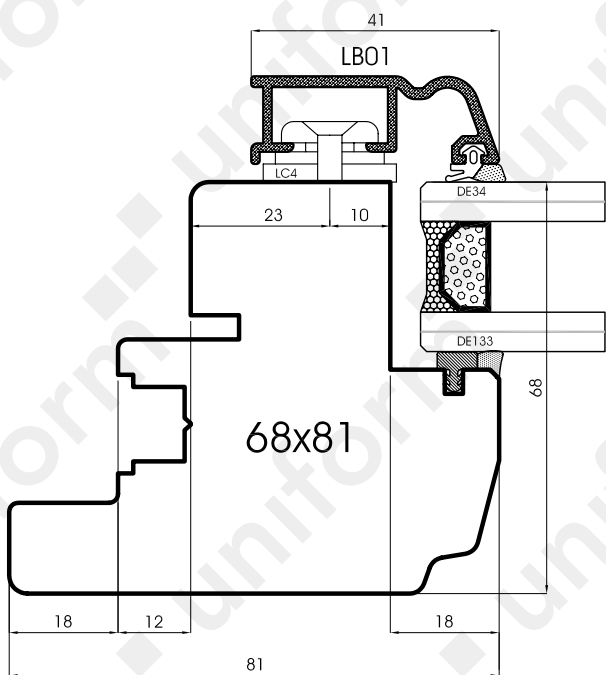

## Bronzo 5000/S

uniform

Scala 0.8:1

11.06

- ① Sezioni orizzontali battenti
- ⓓ Horizontalschnitt Flügel
- ⓔ Secciones horizontales hojas
- ⓕ Coupes horizontales vantaux
- Ⓢ Horizontal sections of the sash

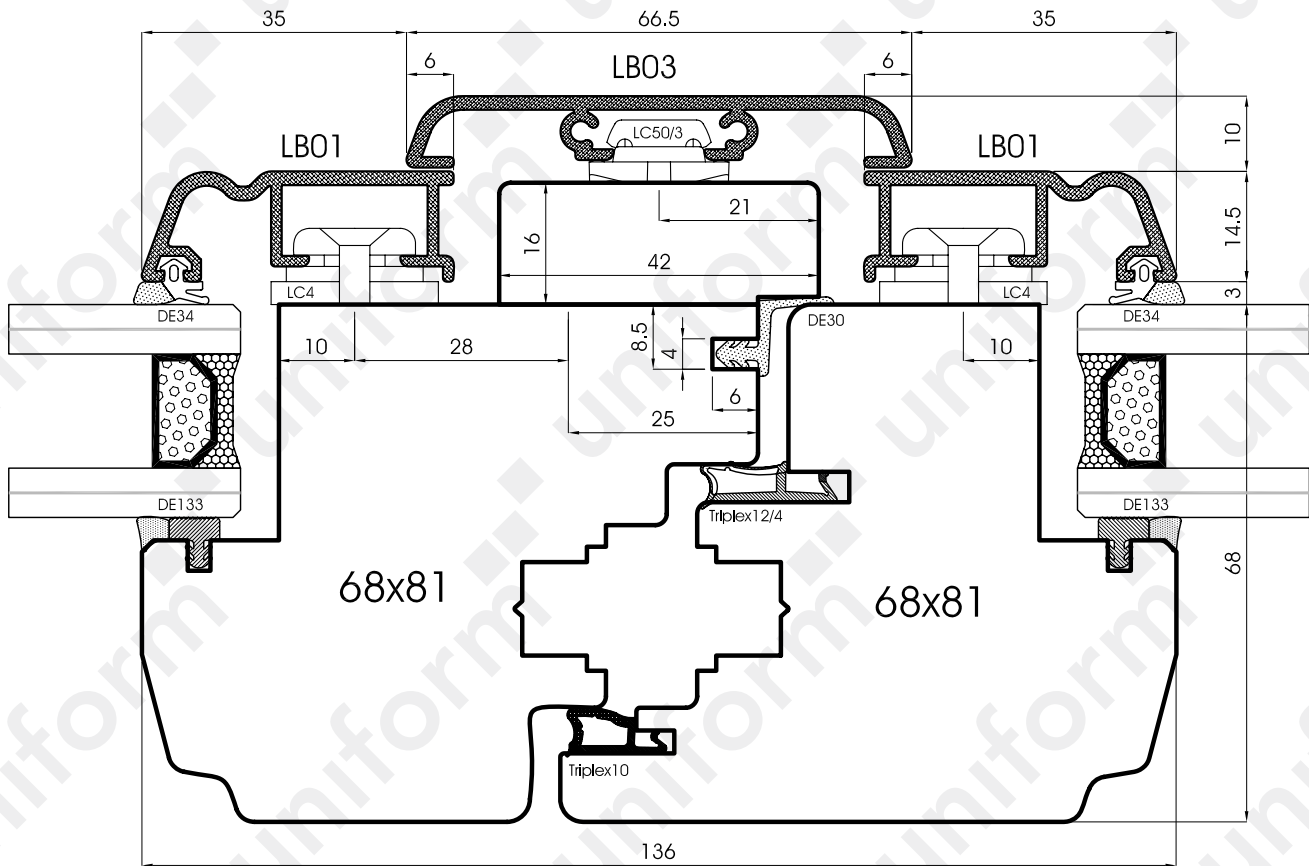
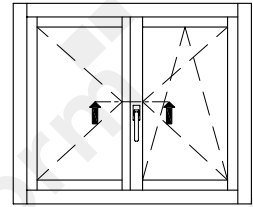

Coppia terminali LC247

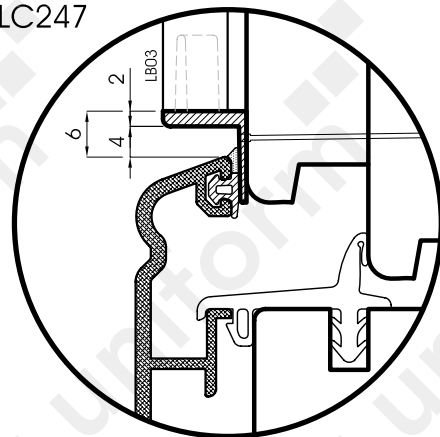
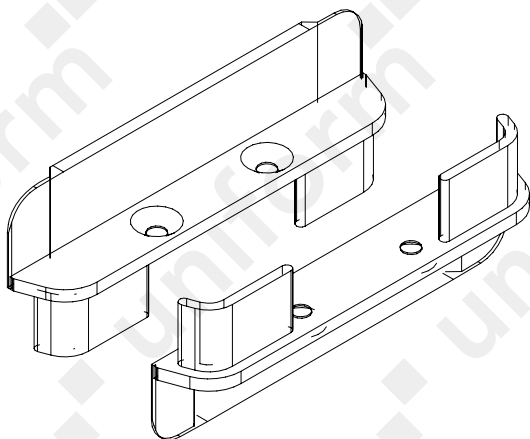

Bronzo 5000/S

uniform

Scala 1:1

11.07

- Ⓘ Sezione orizzontale chiusura centrale con profilo LB03
- Ⓓ Horizontalschnitt Stulpprofil LB03
- Ⓔ Sección horizontal del cierre central con perfil LB03
- Ⓕ Coupe horizontal battement central avec profil LB03
- Ⓚ Horizontal section of the middle clamp with profile LB03



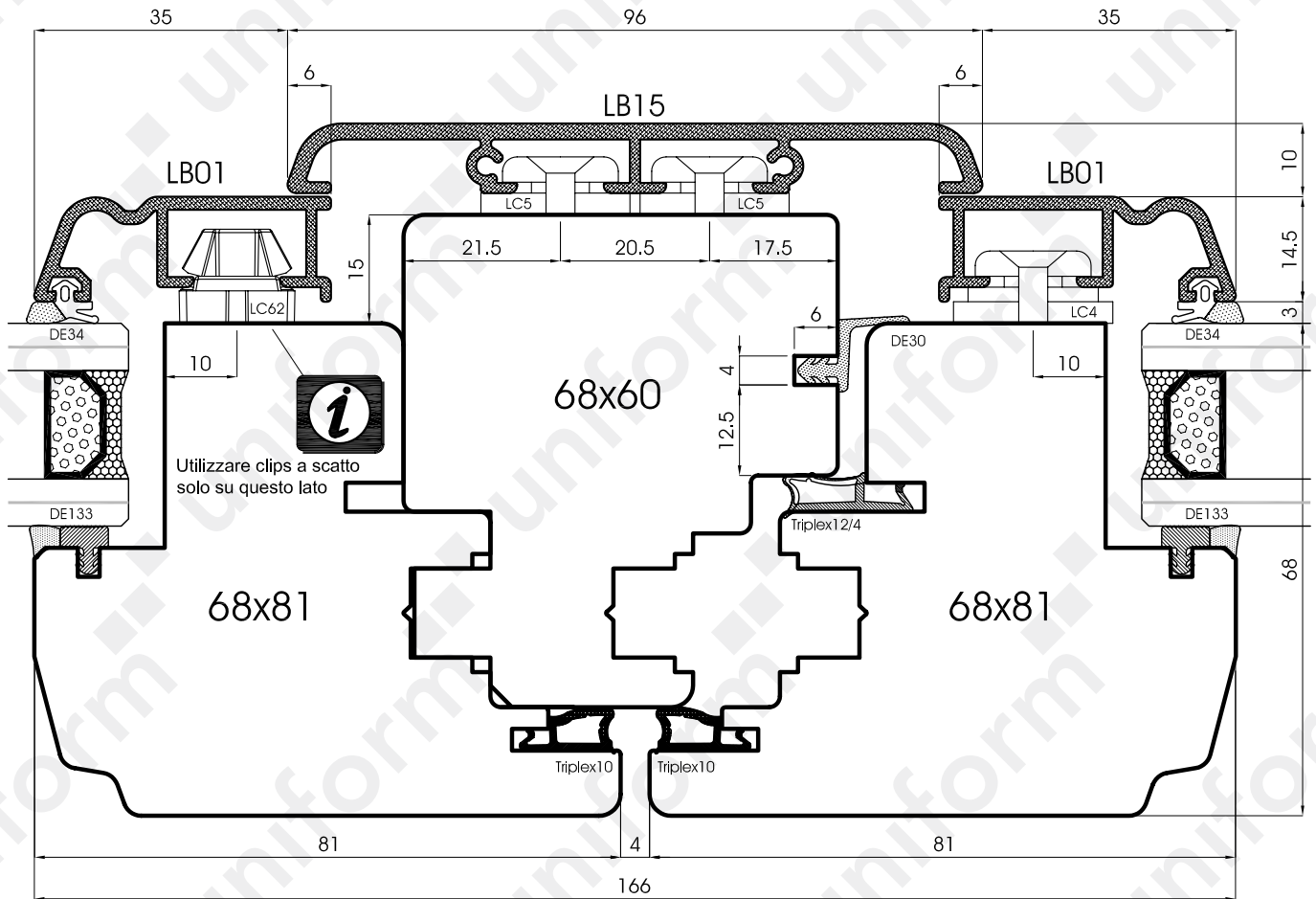
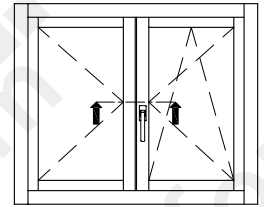

Coppia terminali LC35

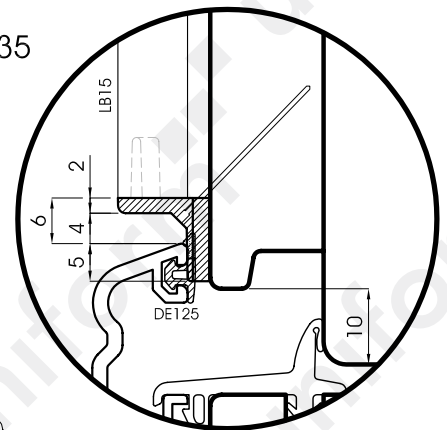
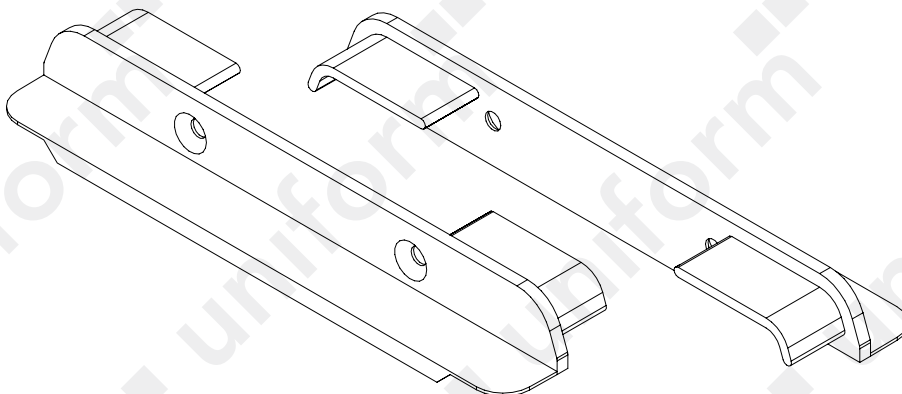

Bronzo 5000/S

uniform

Scala 1:1

11.08

- Ⓘ Sezione orizzontale chiusura centrale con profilo LB15
- Ⓓ Horizontalschnitt Stulpprofil LB15
- Ⓔ Sección horizontal del cierre central con perfil LB15
- Ⓕ Coupe horizontal battement central avec profil LB15
- Ⓚ Horizontal section of the middle clamp with profile LB15



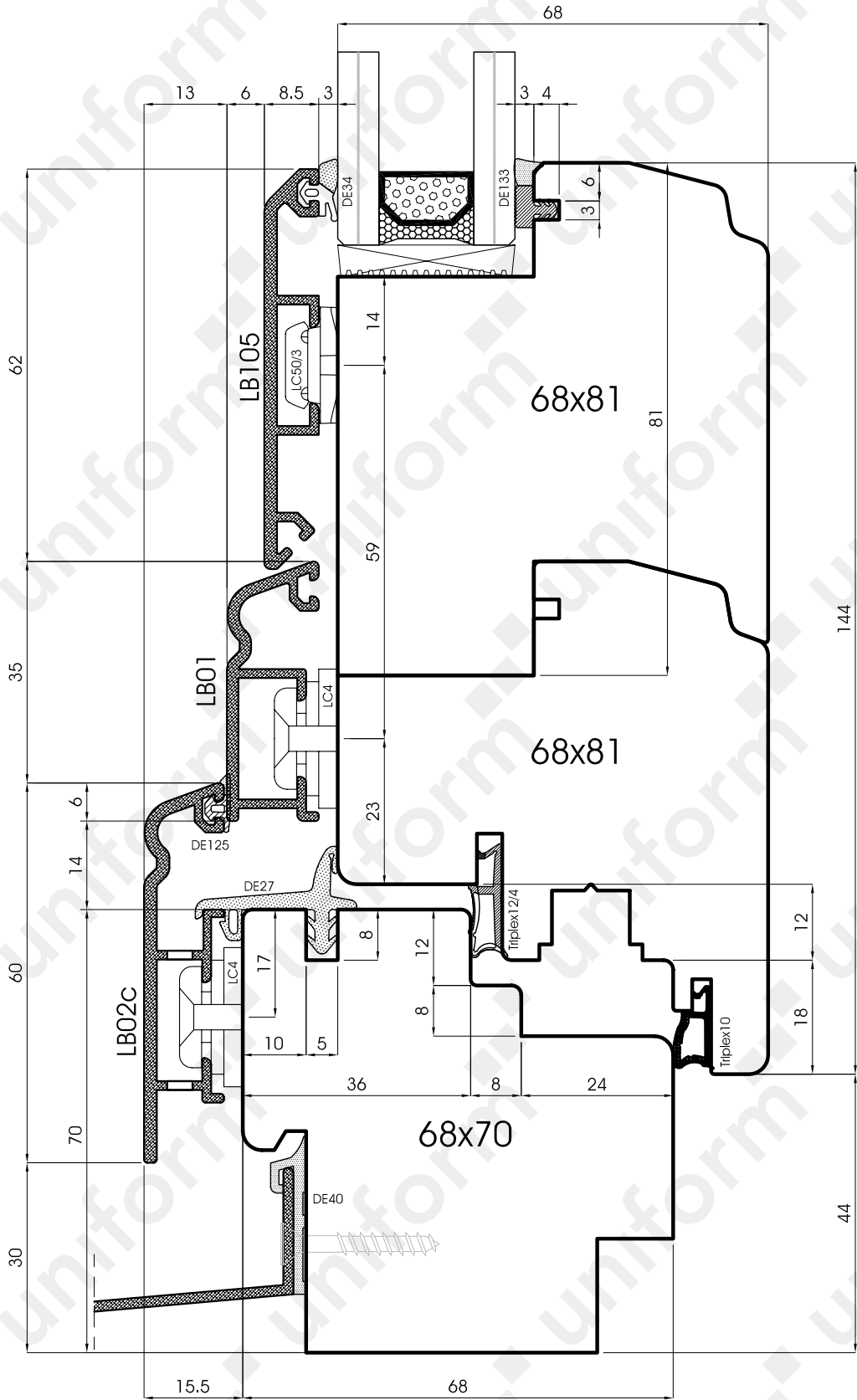
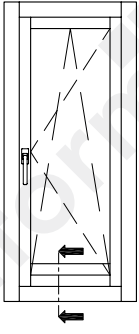

Bronzo 5000/S

uniform

Scala 1:1

11.09

- Ⓘ Sezione verticale trasverso inferiore portafinestra
- Ⓓ Vertikalschnitt Balkontür quer unten
- Ⓔ Sección vertical travesañ inferior puertaventana
- Ⓕ Section verticale traverse inférieure porte-fenêtre
- Ⓚ Vertical section of the window's lower ledger for door-height window

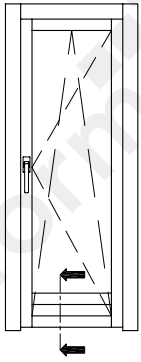

Soglia H 25mm

Soglia H 30mm

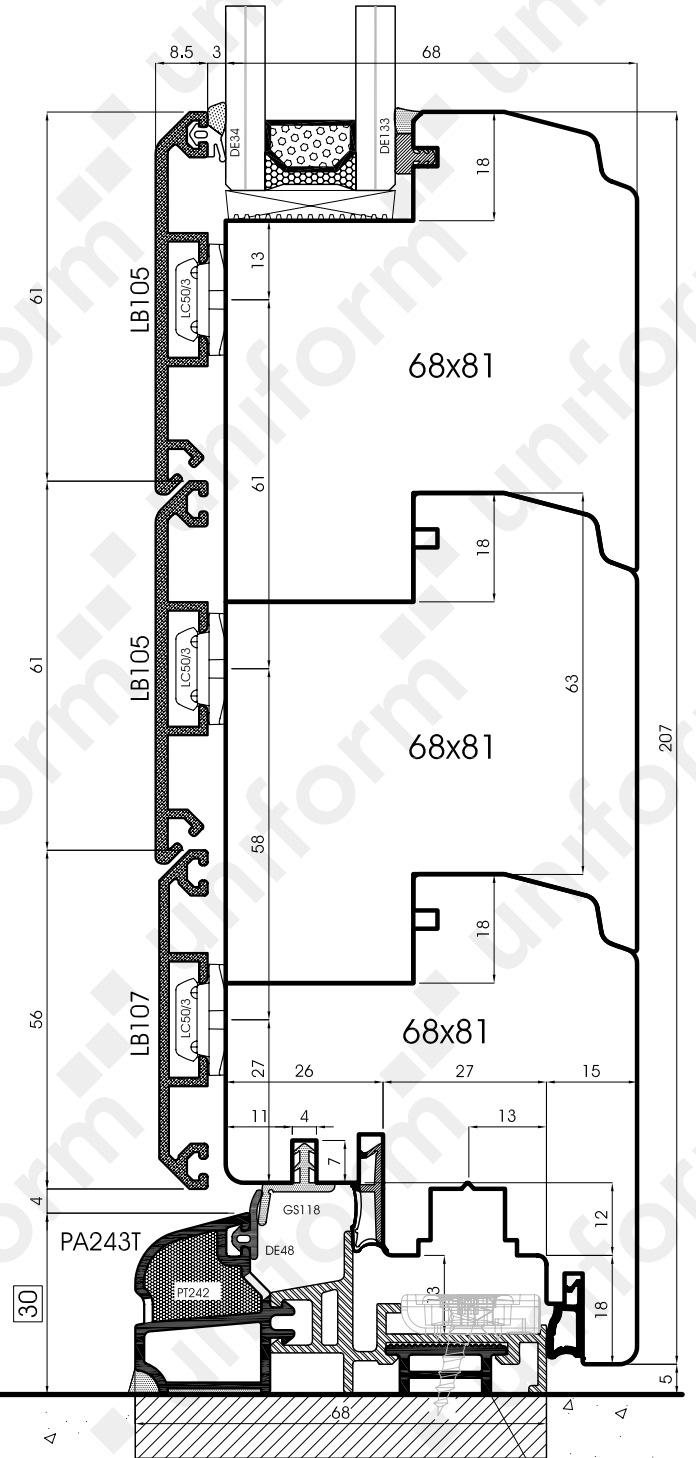
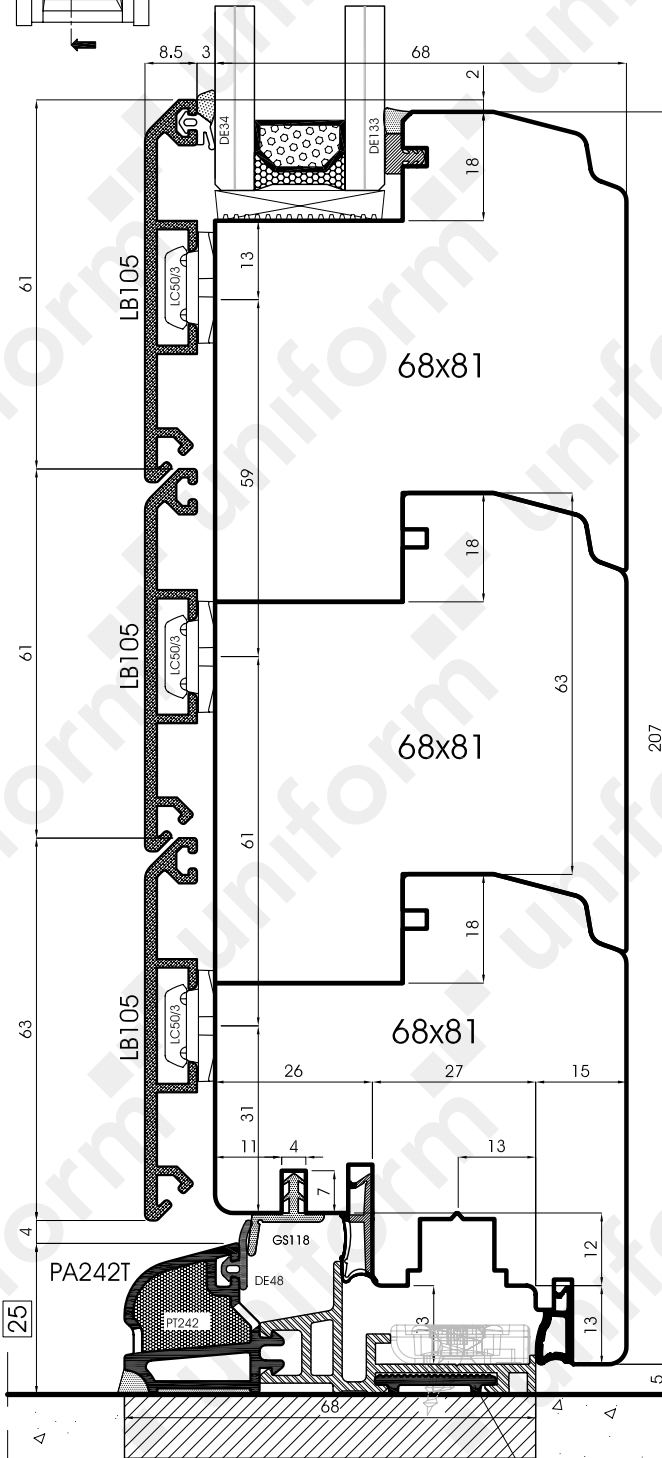

Bronzo 5000/S

uniform

Scala 0.8:1

11.10

- Ⓘ Sezione verticale trasverso inferiore portabalcone con profilo PA242T-PA243T
- Ⓓ Vertikalschnitt Balkontür quer unten mit Profil PA242T-PA243T
- Ⓔ Sección vertical travesaño inferior puertaventana con perfil PA242T-PA243T
- Ⓕ Section verticale traverse inférieure porte-balcon avec profil PA242T-PA243T
- Ⓚ Vertical section of the balcony door's lower ledger with profile PA242T-PA243T



Soglia H 25mm

Soglia H 30mm

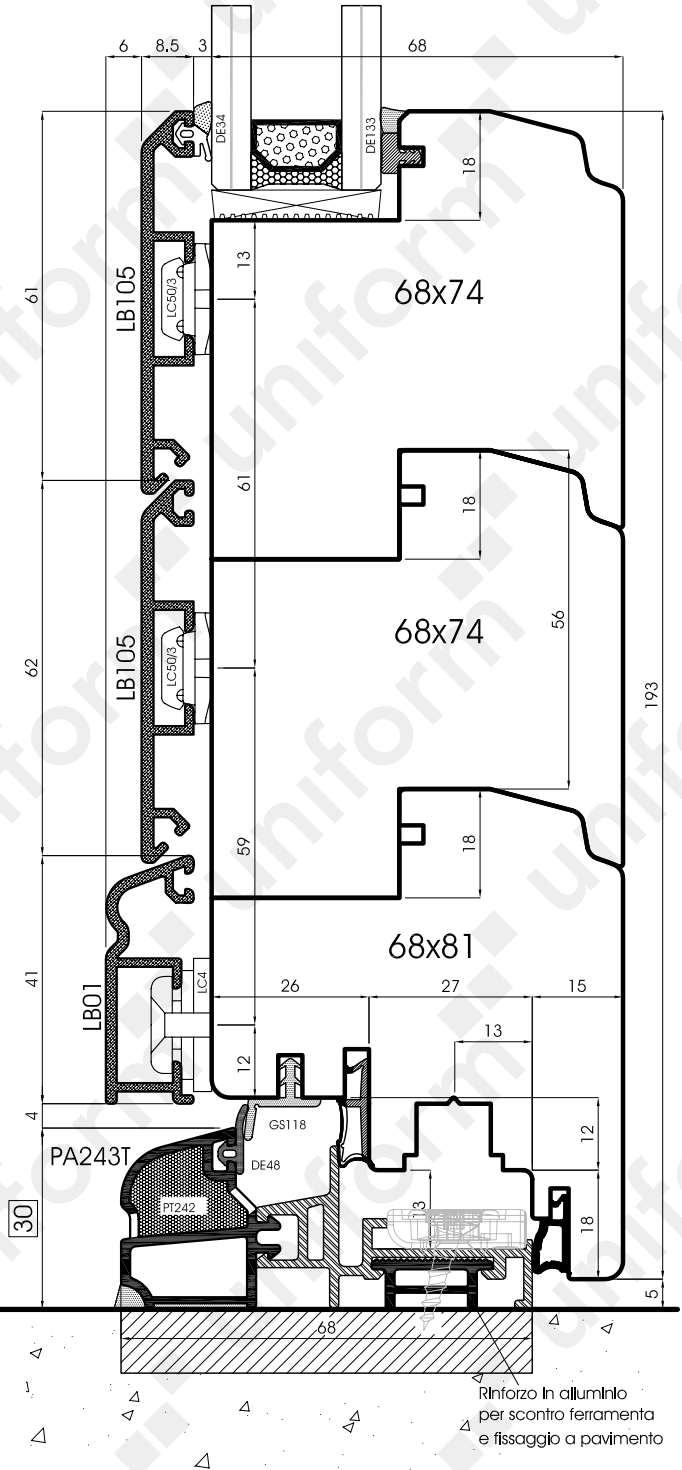
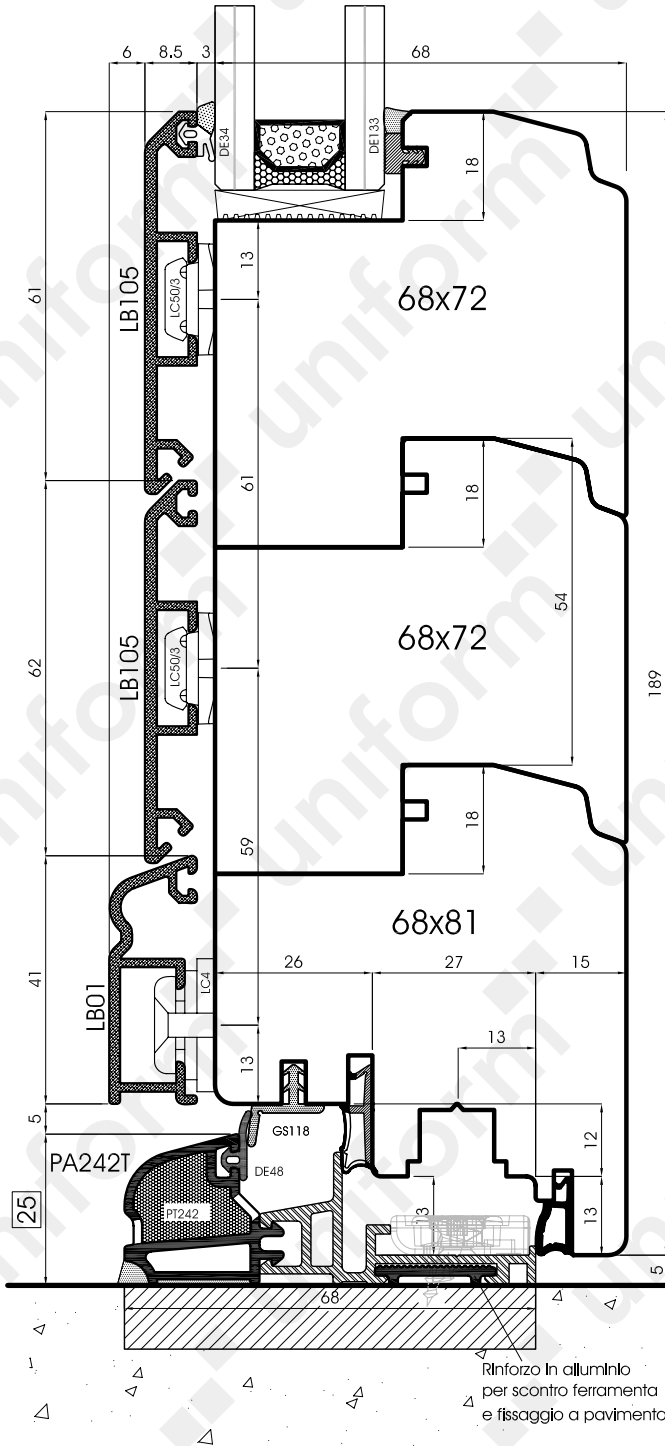

Bronzo 5000/S



Scala 0.8:1

11.11

- Ⓘ Sezione verticale trasverso inferiore portabalcone con profilo PA242T-PA243T
- Ⓓ Vertikalschnitt Balkontür quer unten mit Profil PA242T-PA243T
- Ⓔ Sección vertical travesaño inferior puertaventana con perfil PA242T-PA243T
- Ⓕ Section verticale traverse inférieure porte-balcon avec profil PA242T-PA243T
- Ⓚ Vertical section of the balcony door's lower ledger with profile PA242T-PA243T

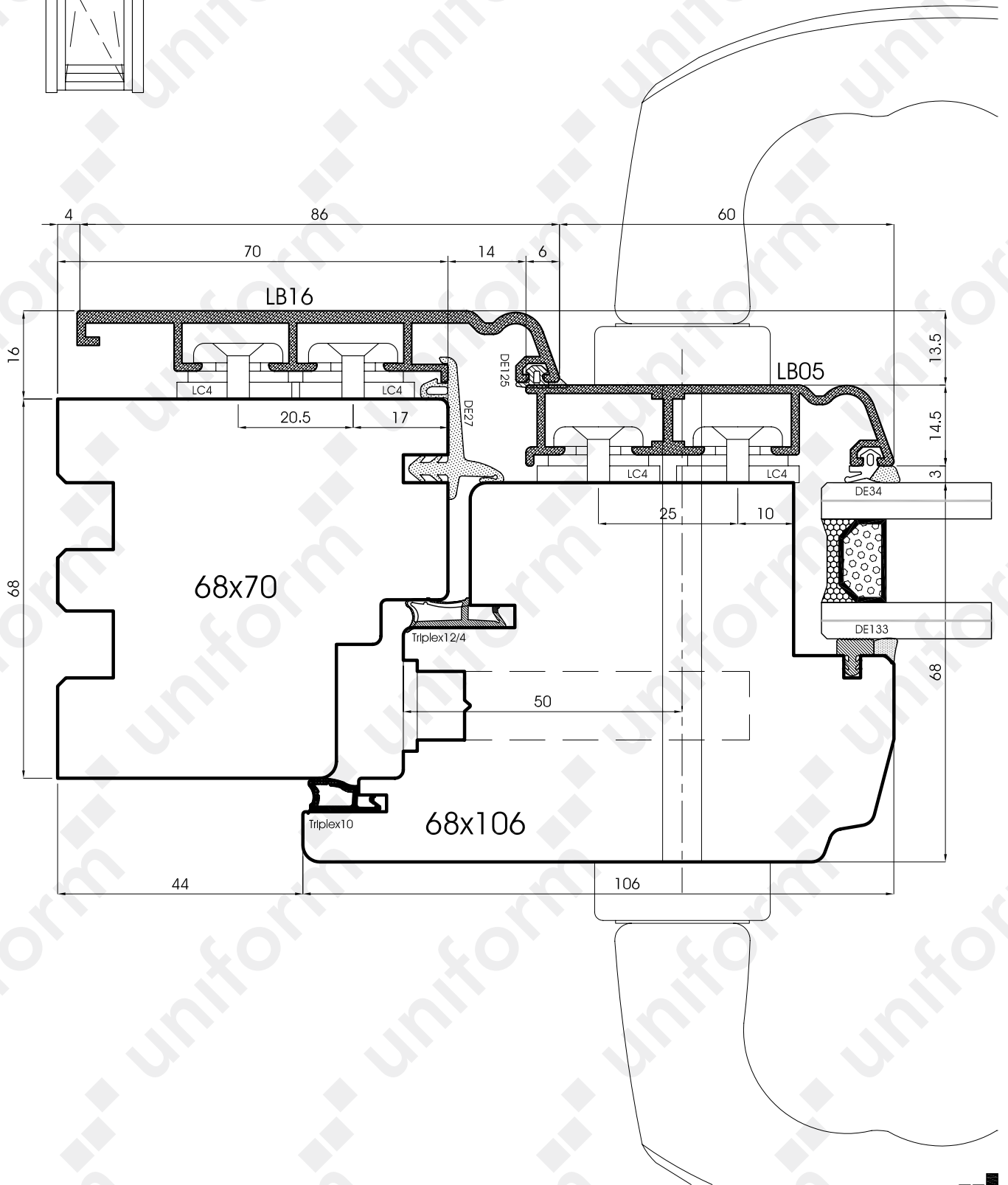
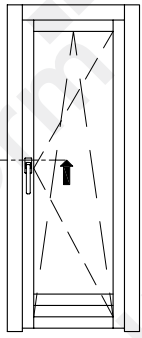

Bronzo 5000/S



Scala 1:1

11.12

- Ⓘ Sezione orizzontale montante laterale
- Ⓓ Horizontalschnitt senkrecht seitlich
- Ⓔ Sección horizontal de montante lateral
- Ⓕ Coupe horizontale montant latéral
- ⒼⓀ Horizontal section of the lateral jamb

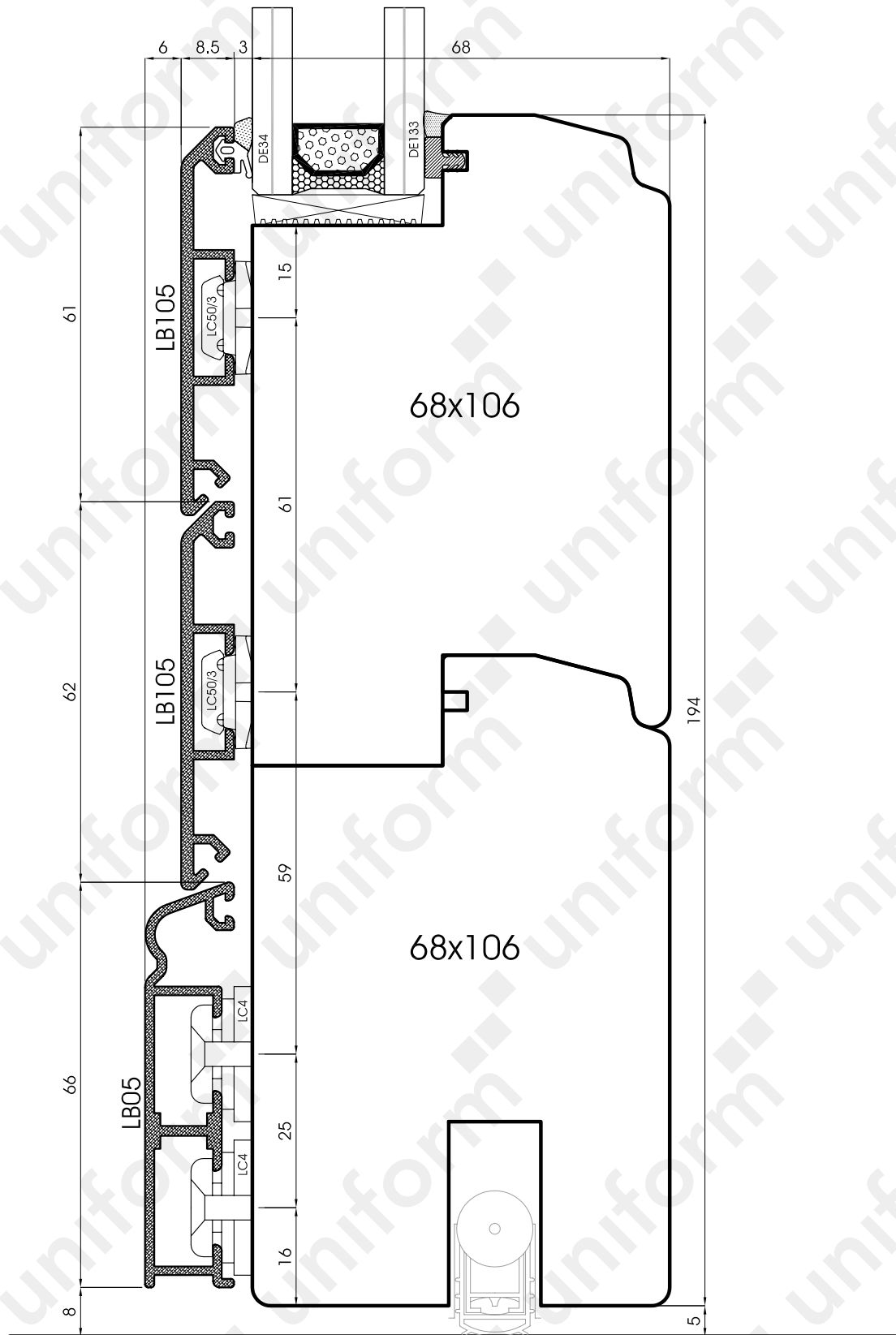
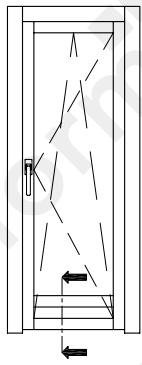

AVVERTENZE: Soluzione non a norme UNI: EN 86, EN 42, 77

Bronzo 5000/S

uniform

Scala 1:1

11.13

- Ⓘ Sezione verticale trasverso inferiore portabalcone con parafreddo
- Ⓓ Vertikalschnitt Balkontür quer unten mit Kälteschutz
- Ⓔ Sección vertical travesaño inferior puertaventana con parafrió
- Ⓕ Section verticale traverse inférieure porte-balcon avec clonette
- Ⓚ Vertical section of the balcony door's lower ledger with cold-defender

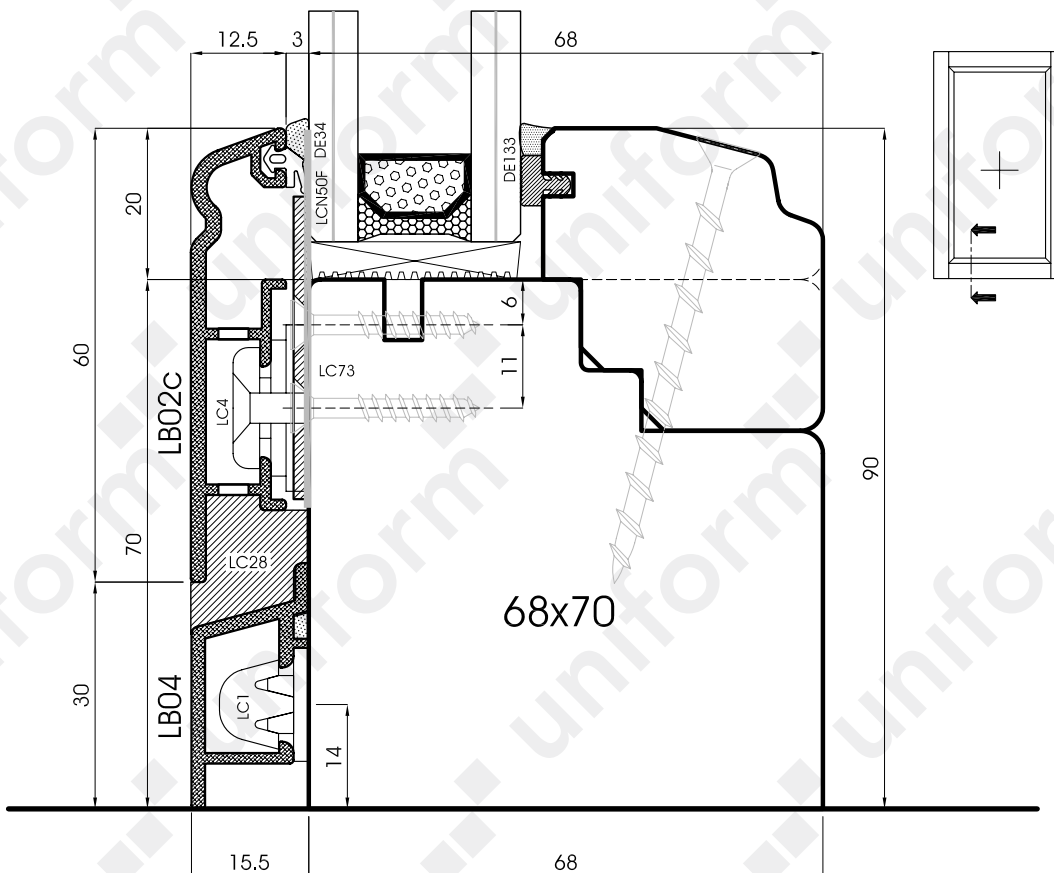
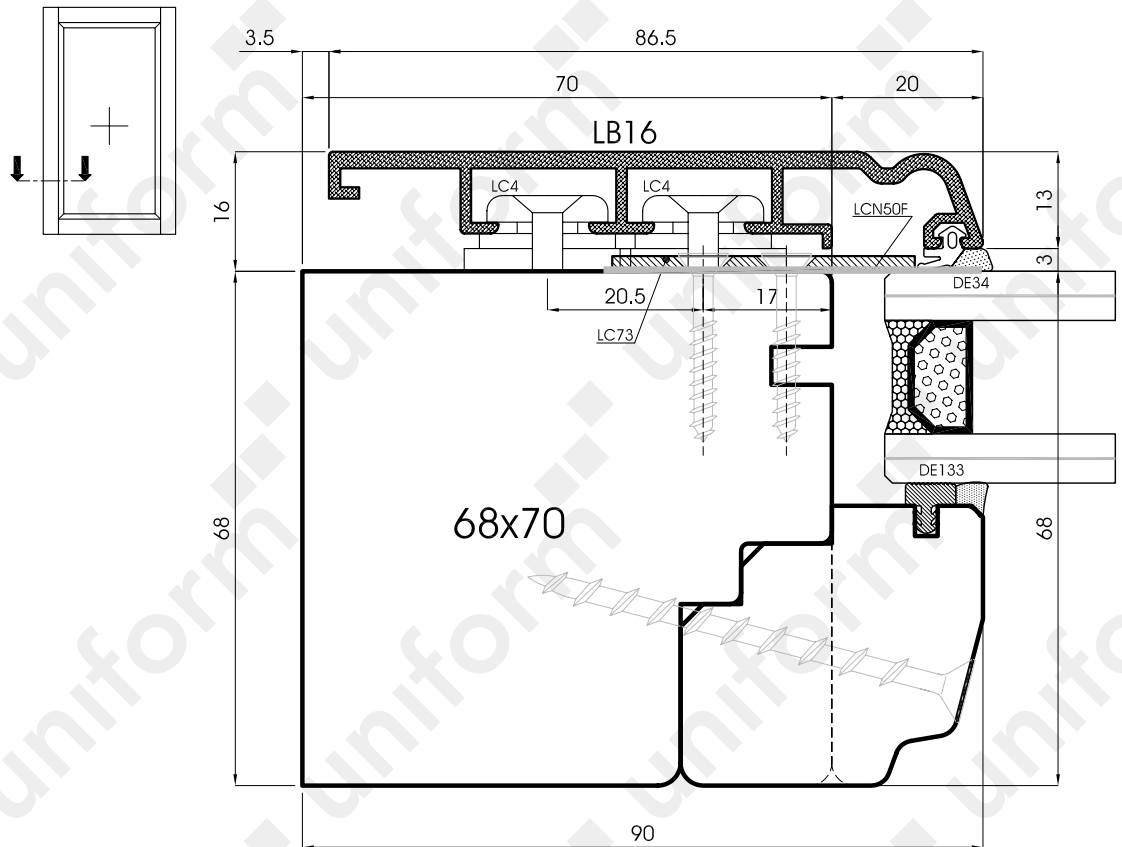

Bronzo 5000/S

uniform

Scala 1:1

11.14

- Ⓘ Sezione verticale finestra con vetro fisso
- Ⓓ Vertikalschnitt Fenster mit Fixverglasung
- Ⓔ Sección vertical ventana con cristal fijo
- Ⓕ Coupe verticale fenêtre avec vitre fixe
- Ⓚ Vertical section of the window's lower ledger with fixed glass

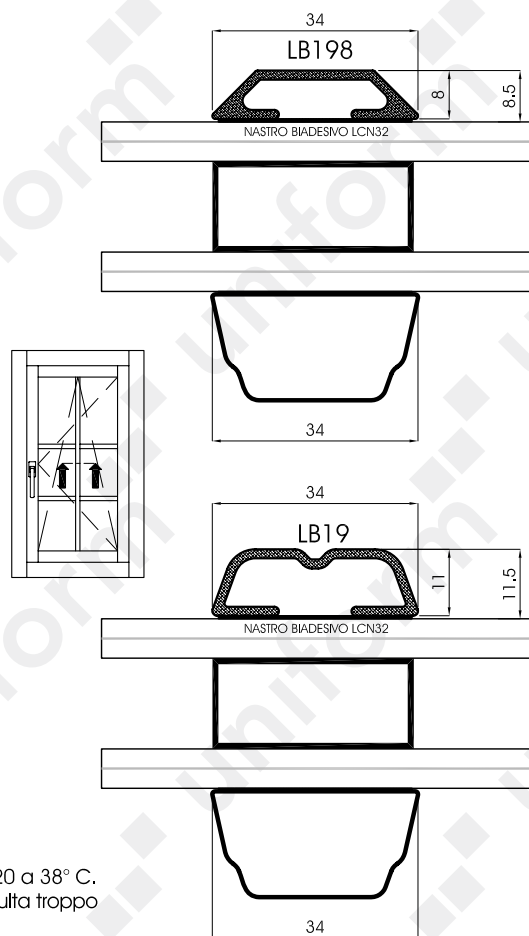
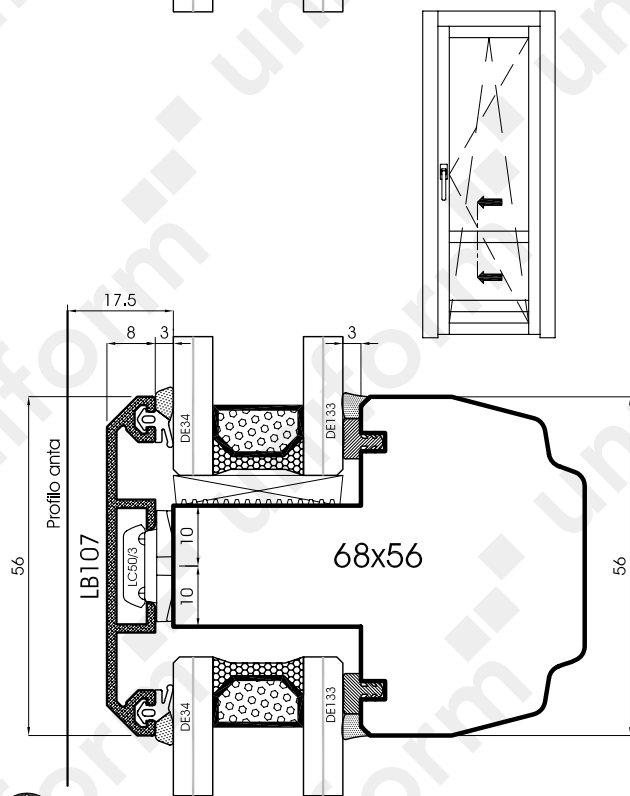
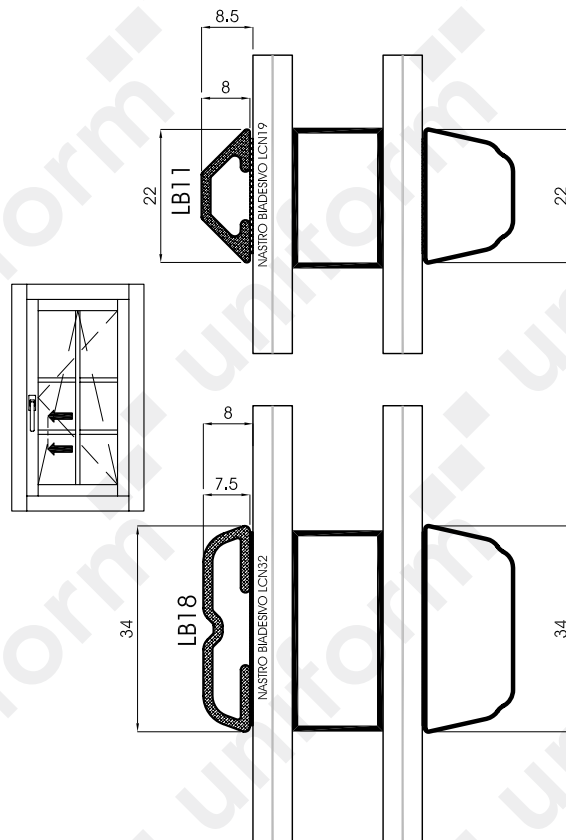
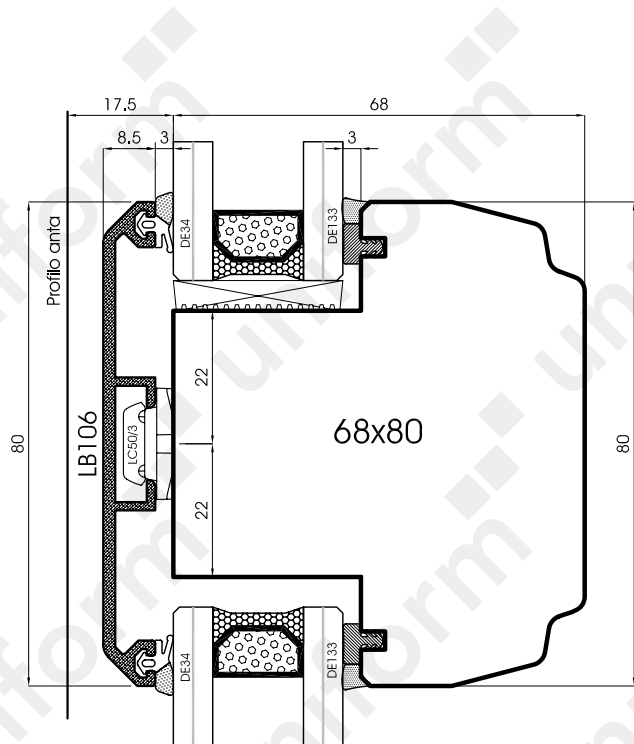

Istruzioni per l'incollaggio degli spossen al vetro:

- Pulire la superficie del vetro con solvente alcolico;
- Pulire la superficie del profilo in bronzo in cui andrà in appoggio il nastro con soluzione LCPRIMER86;
- Fare aderire il nastro al profilo in bronzo e successivamente al vetro, esercitando più possibile una pressione uniforme.

NOTA: la temperatura ideale per l'applicazione del nastro bladesivo è da 20 a 38° C. L'applicazione al di sotto del 10° C è sconsigliata poiché l'adesivo risulta troppo rigido per aderire in modo appropriato.

Bronzo 5000/S

uniform

Scala 0.8:1

11.15

- Ⓘ Sezione verticale traversi intermedi anta
- Ⓓ Vertikalschnitt Sprossen im Flügel
- Ⓔ Sección vertical travesaños intermedios de la hoja
- Ⓕ Coupe verticale traverses intermédiaires vantail
- Ⓚ Vertical section of the sash intermediate rails



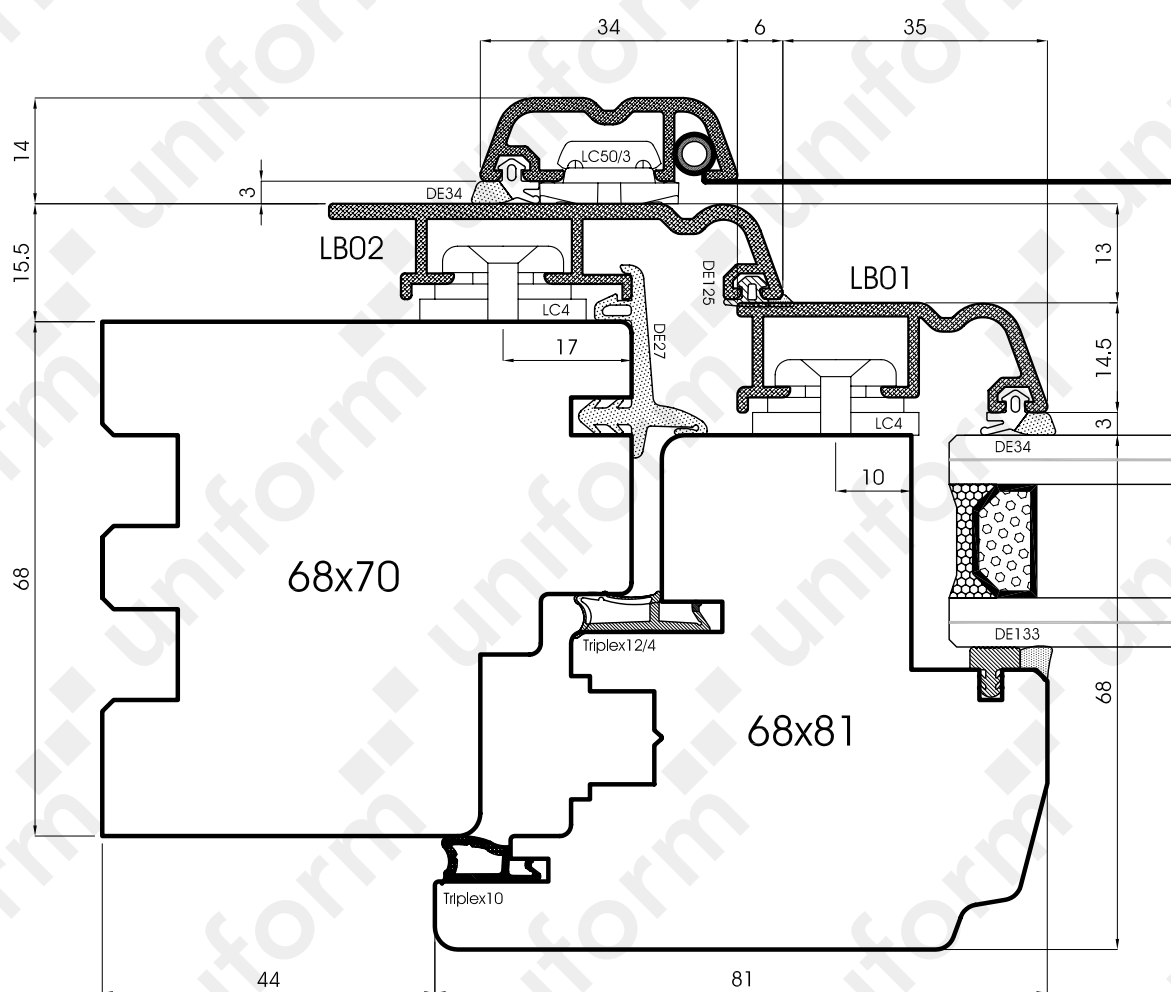
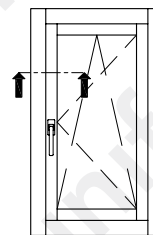

Bronzo 5000/S

uniform

Scala 1:1

11.16

- ① Sezione orizzontale con zanzariera fissa
- Ⓓ Horizontalschnitt Fenster mit vorgesetztem Fliegengitter
- Ⓔ Sección horizontal ventana con mosquitera
- Ⓕ Coupe horizontale avec moustiquaire
- Ⓖ Horizontal section with fixed mosquito-net

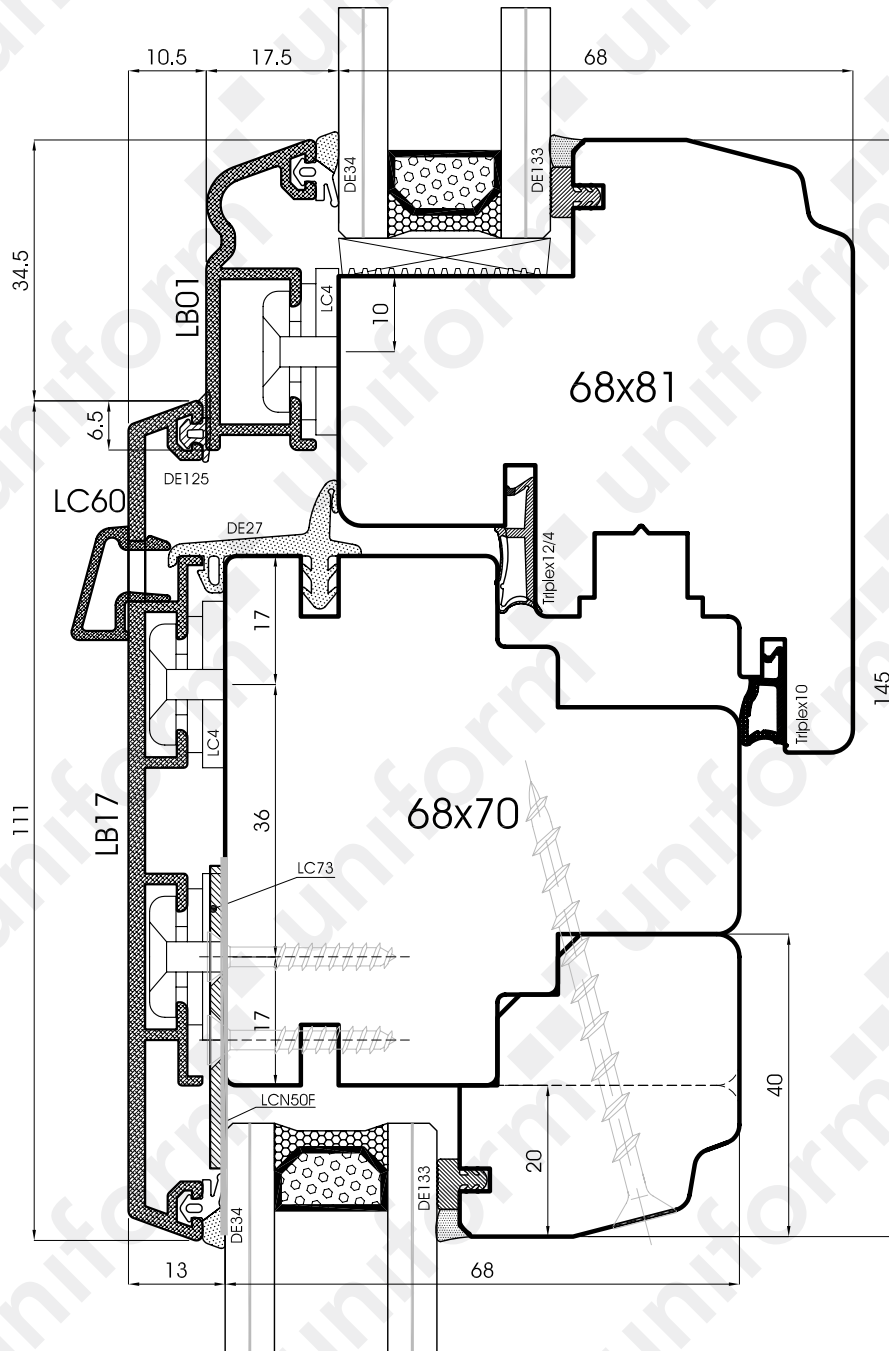
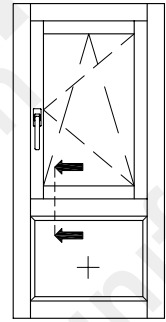

Bronzo 5000/S

uniform

Scala 1:1

11.17

- Ⓘ Sezione verticale traverso intermedio telaio
- Ⓓ Vertikalschnitt Kämpfer
- Ⓔ Sección vertical travesaño intermedio del marco
- Ⓕ Coupe verticale des traverse intermédiaire du dormant
- Ⓚ Vertical section of the frame's intermediate transom

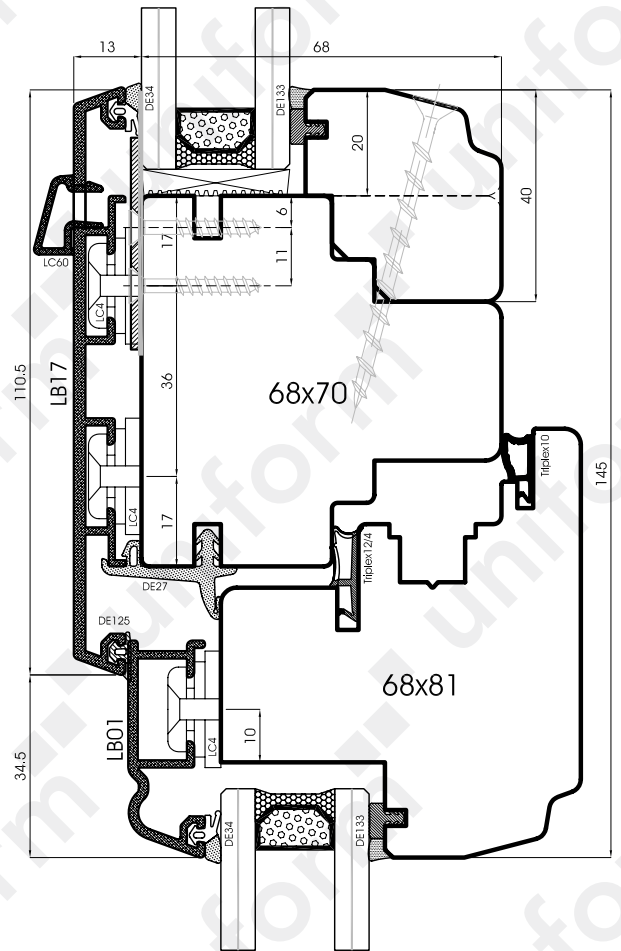
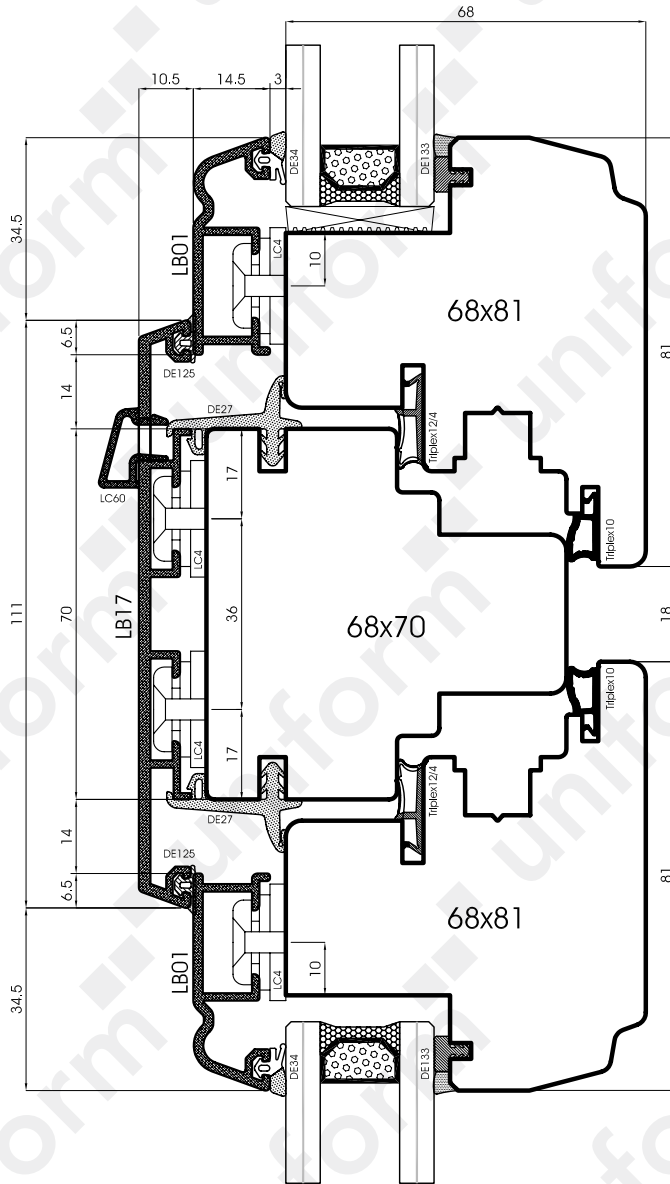
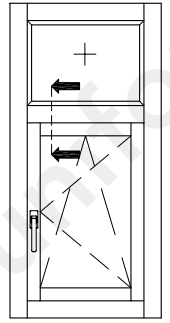
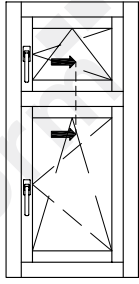

# Bronzo 5000/S



Scala 0.7:1

11.18

- Ⓘ Sezione verticale trasversali intermedi telaio
- Ⓓ Vertikalschnitt Kämpfer
- Ⓔ Sección vertical travesaños intermedios del marco
- Ⓕ Coupe verticale des traverses intermédiaires du dormant
- ⒼⓀ Vertical section of the frame's intermediate transoms

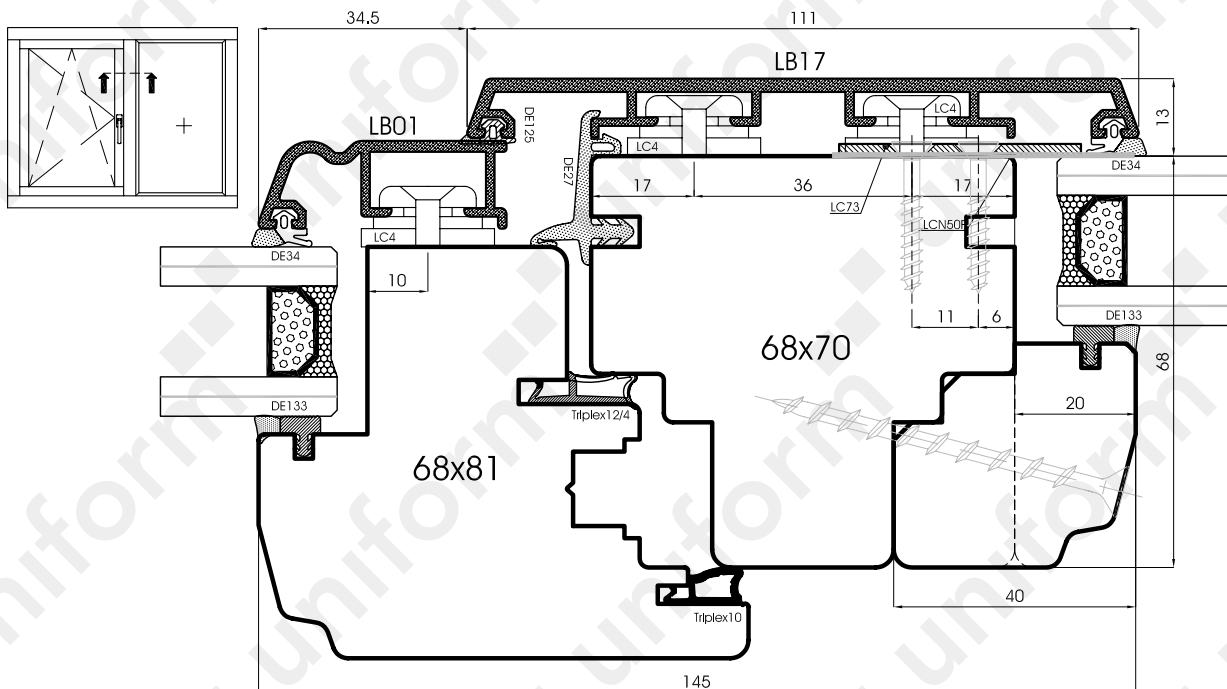
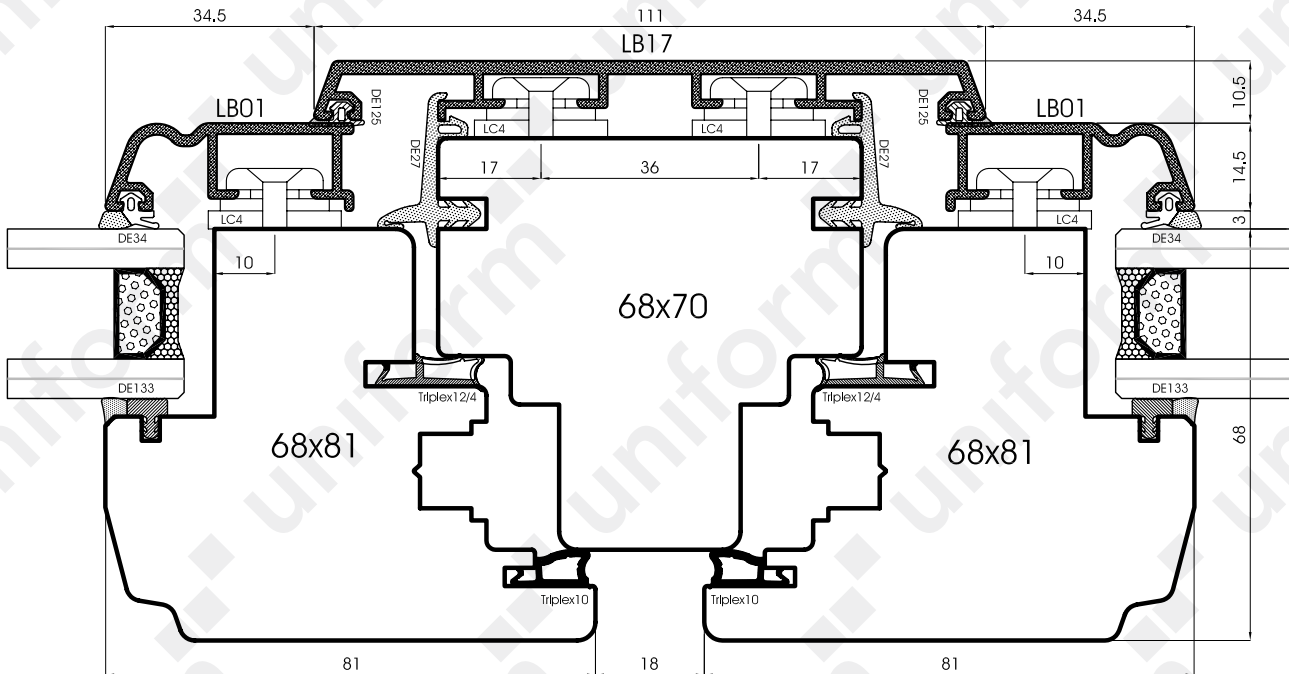
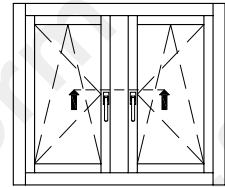

Bronzo 5000/S

uniform

Scala 0.8:1

11.19

- Ⓘ Sezione orizzontale montanti intermedi telaio
- Ⓓ Horizontalschnitt Setzholz Rahmen
- Ⓔ Sección horizontal montantes intermedios del marco
- Ⓕ Coupe horizontale montants intermédiaires dormant
- Ⓞ Horizontal section of the frame's mullions

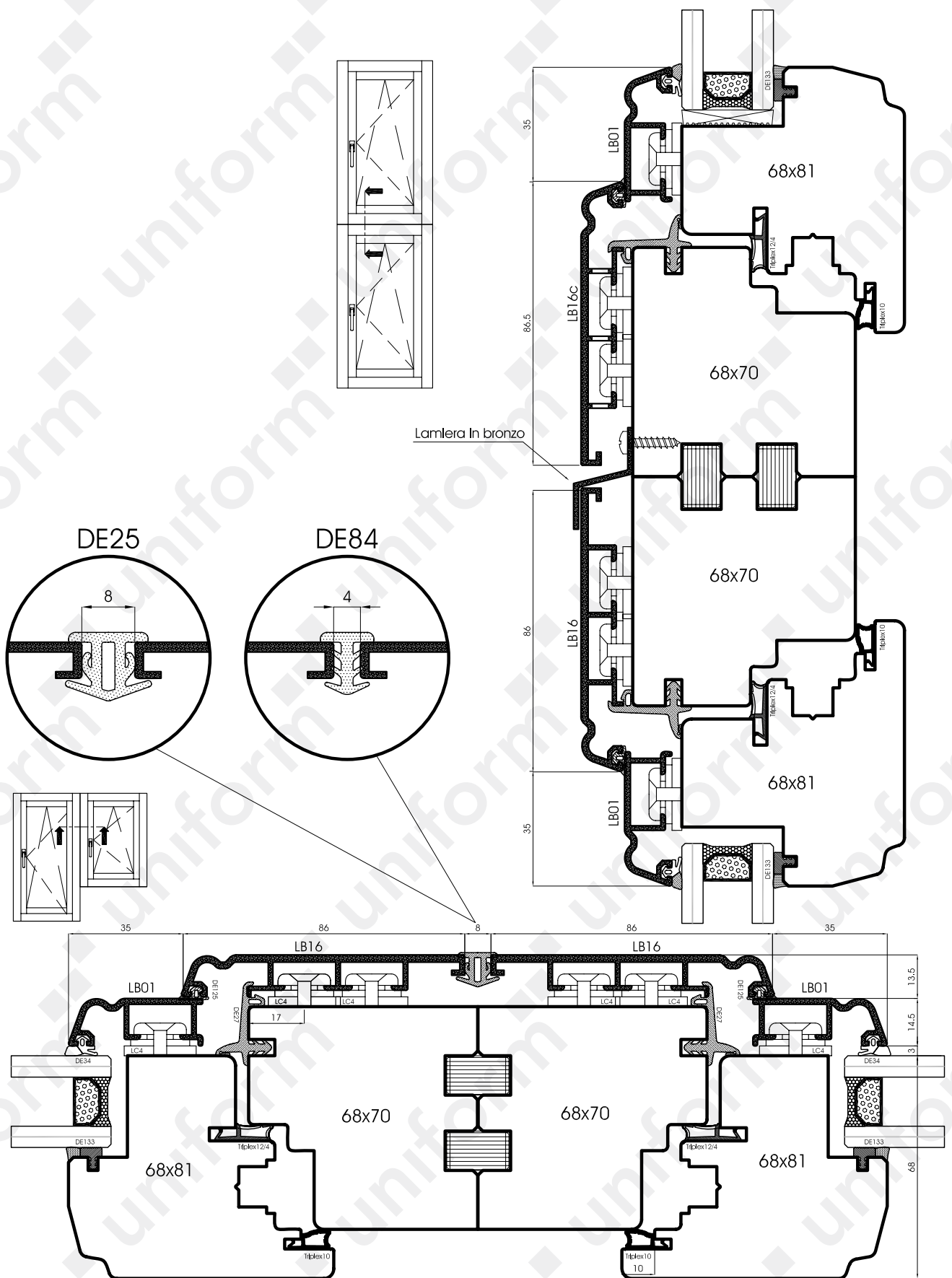

## Bronzo 5000/S

**uniform**

Scala 0,6:1

11.20

- Ⓘ Sezione orizzontale e verticale finestre accoppiate con telaio larghezza 70 mm.
- Ⓙ Horizontal- und Vertikalschnitt gekoppelte Fenster mit Rahmenbreite 70mm
- Ⓚ Sección horizontal y vertical de ventanas acopladas con anchura del marco de madera de 70 mm
- Ⓛ Coupe horizontale et verticale fenêtres accouplement de dormants largeur 70 mm
- Ⓜ Horizontal and Vertical section of the connected windows with a frame's breadth of 70mm

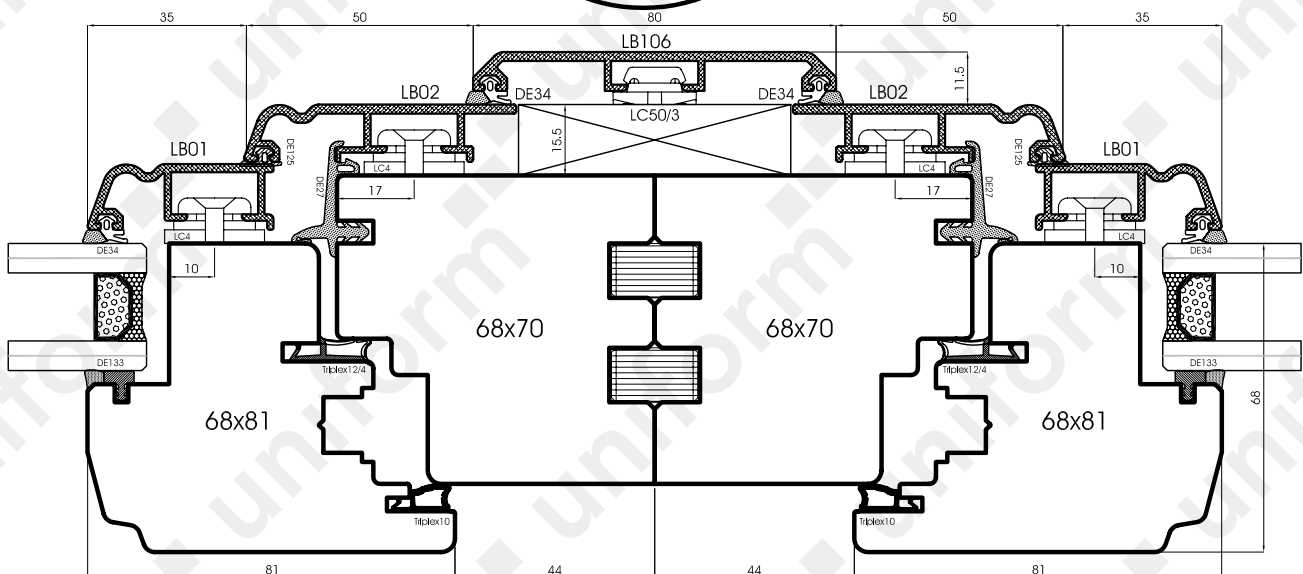
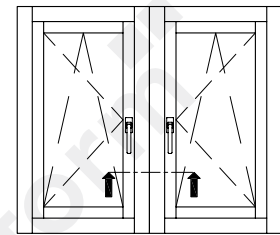
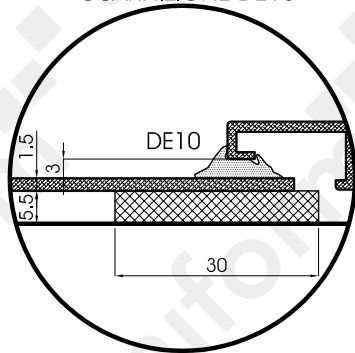
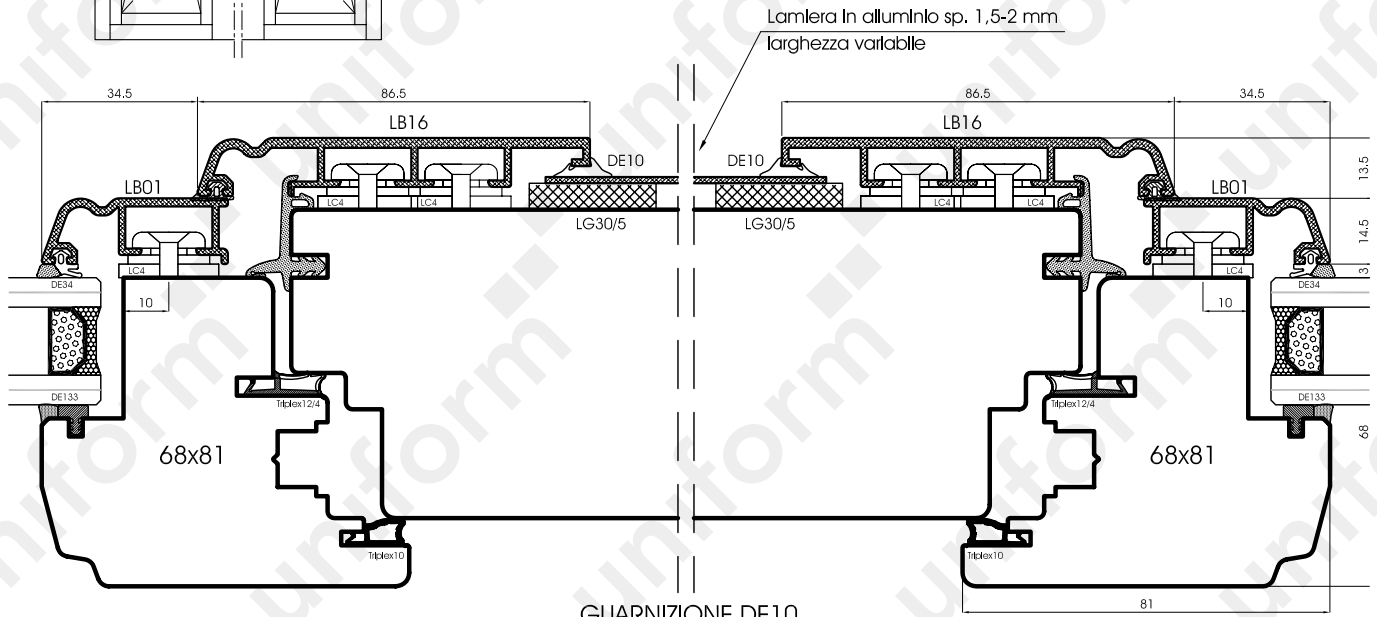
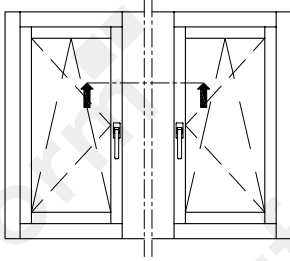

Bronzo 5000/S

uniform

Scala 0.6:1

11.21

- Ⓘ Sezione orizzontale finestre accoppiate
- Ⓓ Horizontalschnitt gekoppelte Fenster
- Ⓔ Sección horizontal de ventanas acopladas
- Ⓕ Coupe horizontale accouplement de dormants
- Ⓚ Horizontal section of the connected windows